

# INSTALLATION INSTRUCTIONS

## Ceiling Application Only

### REQUIRED TOOLS AND MATERIALS:

- ◆ Hammer
- ◆ Nails
- ◆ Saw
- ◆ Construction Adhesive
- ◆ Tape Measure
- ◆ Stud Finder

**NOTE** ATTIC SPACE ABOVE PORCH SHOULD BE VENTED.

**NOTE** AIR TEMPERATURE SHOULD BE 65°F TO 75°F DURING INSTALLATION.



**CAUTION** CEILING PLANK SHOULD NEVER BE USED FOR LOAD-BEARING APPLICATIONS.

### INSTALLATION:

1. Allow  $\frac{1}{4}$ " on each end for expansion.

2. With the nailing fin positioned away from the wall, face nail the first piece against one side of the ceiling. Nail the nailing fin on the first piece on **maximum 16" centers**.

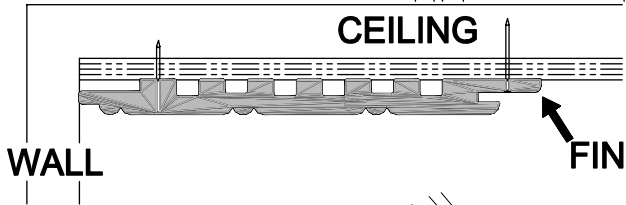
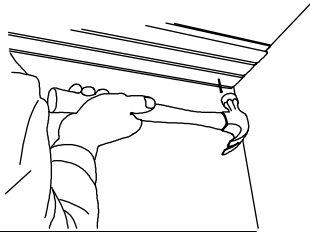

3. Insert the next piece into the slot and continue nailing through the fin on **maximum 16" centers** until ceiling is completely covered.

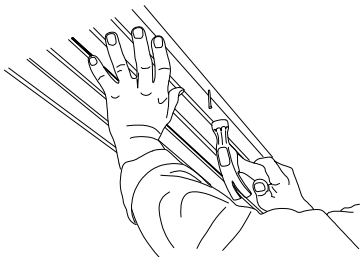

4. Use PVC cement where plank ends must be butted together.

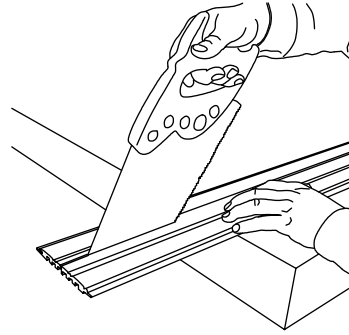
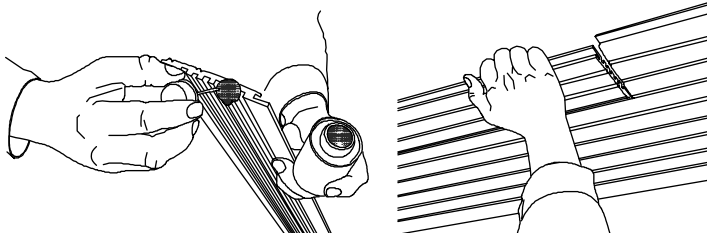

5. The last piece will probably need its width adjusted. Measure mark and rip it to the desired width.

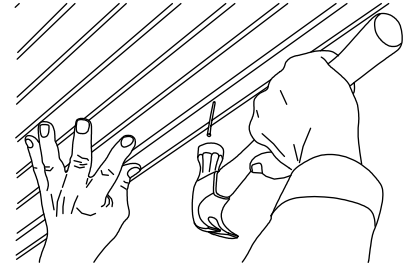

6. Face nail the last piece as close to the wall as possible.

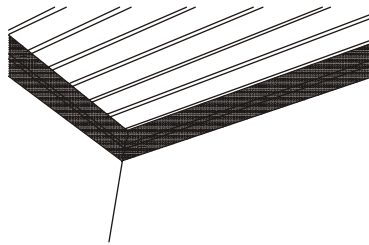

7. Cover edges with Cellular PVC crown or end trim moulding.

REV 08A-2004